

PIHLAJANIEMEN MAANKÄYTÖN  
YLEISSUUNNITELMA 06.09.2019



Sennaatti

Gehl  
Architects

ARKKITEHTITOIMISTO  
AJAK





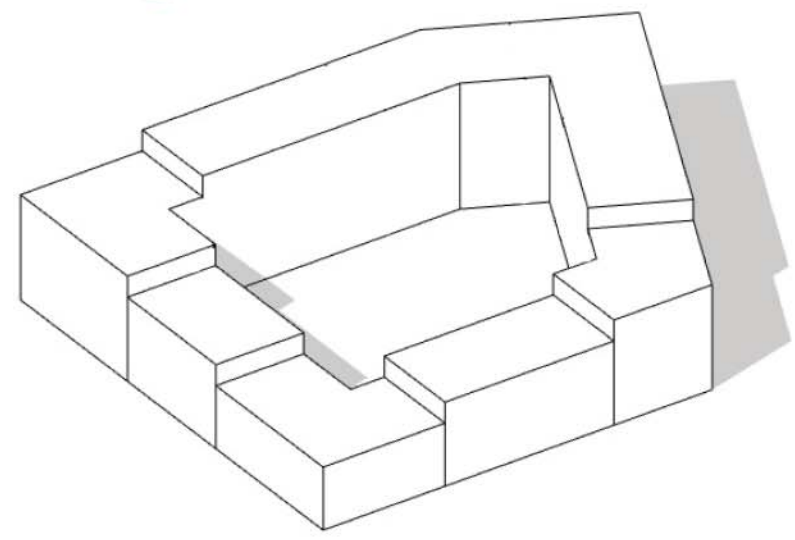
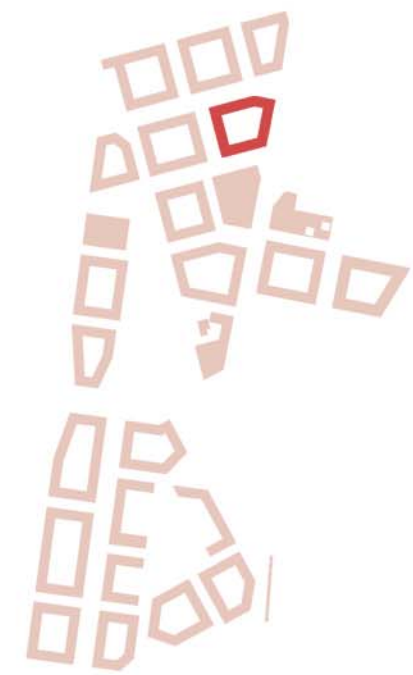
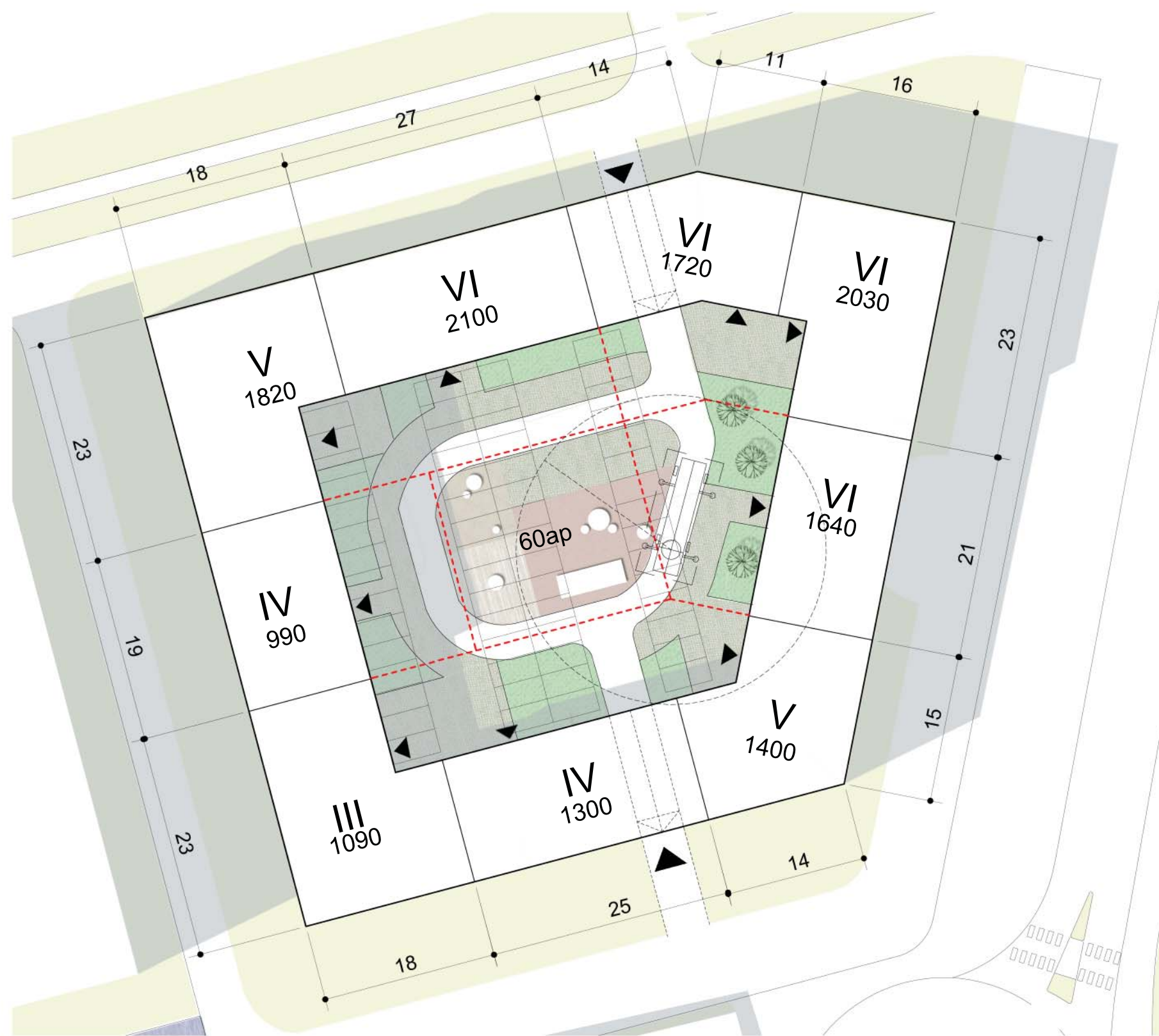

Korttelin kokonaiskerrosala:  
14090 kem<sup>2</sup>

1 ap/125 kem<sup>2</sup> --> 14090/125= 113ap  
Kannen alla 60 ap  
--> Parkkihalliin 53 ap